

Instructions for the Trident Internal Standard Kit

Part Number 60-808-1185

INS-0024



GLASS EXPANSION

Quality By Design

Parts Included

Description

Part Number

1. Internal standard probe	60-808-1187
2. EzyFit glass mixing chamber/tee	60-808-1190
3. EzyFit Sample tube, twin	EZT-16-50T x1
4. UniFit- EziFit sample tube	UFT-EZT-16-50-1
5. EzyFit sample tube 0.5mm ID	EZT-16-50 x1
6. EzyFit internal standard tube, 0.25mm ID	EZT-16-25 x1
7. Vitex Gripping Paper (pkt 6)	KK711E
8. Flared connector	70-803-0924

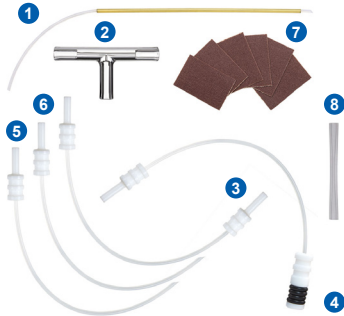

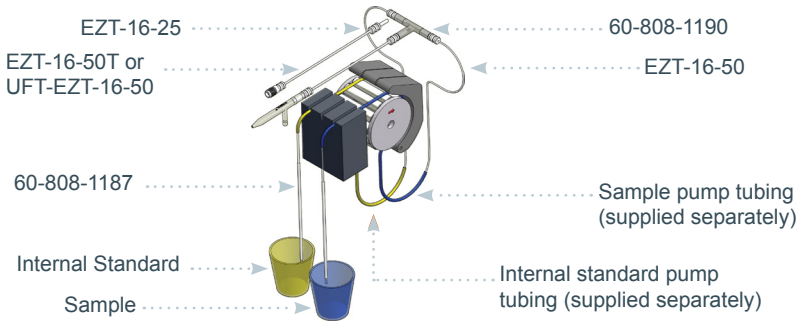

Assembly of the Trident Internal Standard Kit

For nebulizers with EzyFit connector:

1. Attach one end of EZT-16-50T to the mixing chamber/tee (60-808-1190) by inserting the Teflon plug all the way into the mixing chamber end of the tee.
2. Attach the other end of EZT-16-50T into the end of the nebulizer.

Or, for a U-Series nebulizer:

1. Attach the EzyFit end of UFT-EZT-16-50 to the mixing chamber/tee (60-808-1190) by inserting the Teflon plug all the way into the mixing chamber end of the tee.
2. Attach the UniFit end of UFT-EZT-16-50 to the nebulizer.

If you do not have a Glass Expansion nebulizer with the EzyFit connection or a U-Series nebulizer, simply cut off the EzyFit from EZT-16-50T and connect the end to the nebulizer tubing using the flared connector 70-803-0924.

3. Attach the sample capillary (EZT-16-50) to one arm of the tee by inserting the Teflon plug as far as it will go. The plug should be butted against the capillary channel of the tee to minimize washout times.
4. Attach the IS capillary (EZT-16-25) to the remaining arm of the tee in the same fashion.
5. Attach the other ends of the sample and IS capillaries into the appropriate pump tubes.

Glass Expansion Contour flared-end pump tubing is specially made to facilitate attachment to the capillary tube. This is especially important for the small ID IS pump tubing. The Contour tubing can be purchased in 6-packs by adding a “-F” to the end of the normal tubing P/N.

1. Attach the capillary of the IS probe (P/N 60-808-1187) into the other end of the IS pump tubing and insert the probe into your IS solution.
2. Connect your autosampler (or sample) capillary into the other end of the sample pump tubing.

International

6 Central Boulevard, Port Melbourne, Vic 3207, Australia

Telephone: +61 3 9320 1111

Email: enquiries@geicp.com

Facsimile: +61 3 9320 1112

Americas

31 Jonathan Bourne Drive, Unit 7 Pocasset, MA 02559, USA

Toll Free Phone: 800 208 0097

Telephone: 508 563 1800

Facsimile: 508 563 1802

Email: geusa@geicp.com



GLASS EXPANSION

Quality By Design